

Terminations

Duraband® Type P2 – Quick Disconnect Plugs

Continued from previous page...

Type P2 □ – Low Profile Assembly

- P2F** – Low profile assembly only
- P2G** – w/straight plug only
- P2H** – w/str. plug and galvanized cable
- P2J** – w/str. plug and SS cable
- P2K** – w/str. plug and wire braid

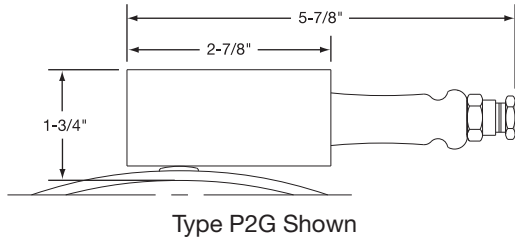

One-Piece Band

Standard Termination Location:
next to gap; center of width

- * **Minimum Inside Diameter:** 3" (76.2 mm)
- * **Minimum Width:** 2-1/2" (63.5 mm)

Plug Electrical Ratings

- * **2-Pole 3-Wire Grounding**
- * **Maximum Volts:** 250 VAC
- * **Maximum Amps:** 16A
- * **Maximum Temperature:** 392°F (200°C)

Two-Piece Band

Standard Termination Location:
next to same gap on each half;
center of width

- * **Minimum Inside Diameter:** 3" (76.2 mm)
- * **Minimum Width:** 2-1/2" (63.5 mm)

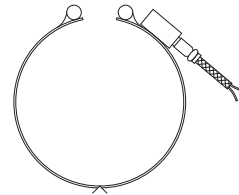
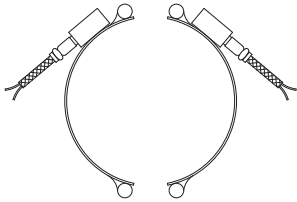

One-Piece Expandable Band

Standard Termination Location:
next to gap; center of width

- * **Minimum Inside Diameter:** 3" (76.2 mm)
- * **Minimum Width:** 2-1/2" (63.5 mm)

Duraband Type P3 – DIN 49458 A/B Quick Disconnect Plugs

One-Piece Band

Standard Termination Location:
next to gap; center of width

- * **Minimum Inside Diameter:** 3" (76.2 mm)
- * **Minimum Width:** 1-1/2" (38.1 mm)

Plug Electrical Ratings

- * **2-Pole 3-Wire Grounding**
- * **Maximum Volts:** 250 VAC
- * **Maximum Amps:** 16A
- * **Maximum Temperature:** 392°F (200°C)



Standard Pin Orientation



Type P3 □ – Vertical Box Assembly

- P3A** – Box assembly only
- P3B** – Box assembly w/straight plug
- P3C** – Box assembly w/right-angle plug only

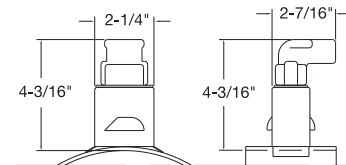

Two-Piece Band

Standard Termination Location:
next to same gap on each half;
center of width

- * **Minimum Inside Diameter:** 3" (76.2 mm)
- * **Minimum Width:** 1-1/2" (38.1 mm)

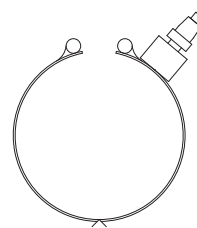
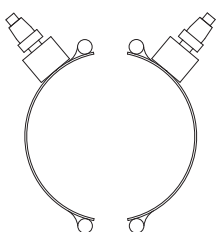

One-Piece Expandable Band

Standard Termination Location:
next to gap; center of width

- * **Minimum Inside Diameter:** 3" (76.2 mm)
- * **Minimum Width:** 1-1/2" (38.1 mm)